

COMMERCIAL SAMPLE SITE PLAN

Do not use this example as your site plan. Use page 2 to create your site plan.

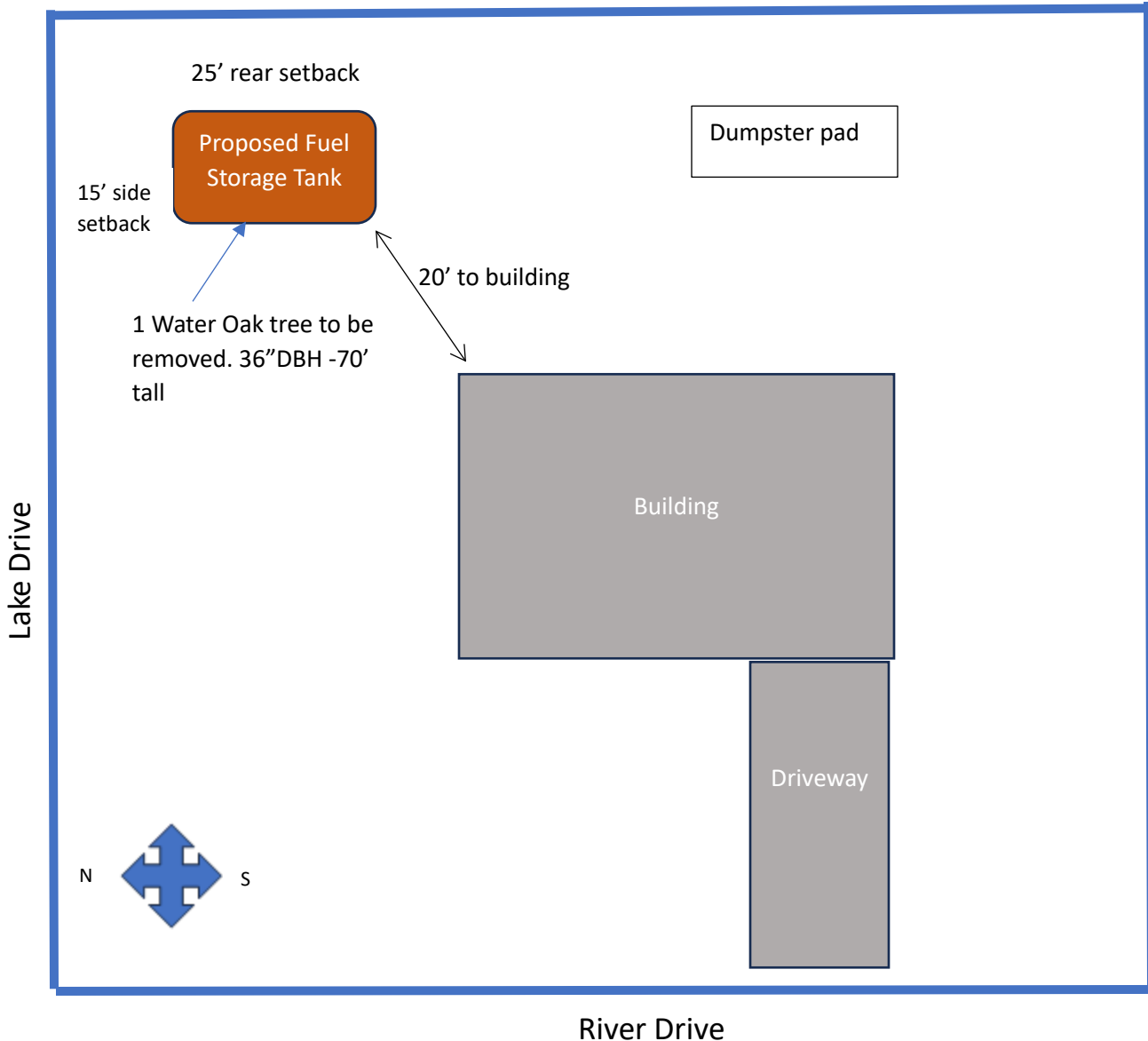

The following must be included on the site plan. Measurements should be identified in feet.

1. Indicate North, South, East and West.
2. Identify location of proposed structure(s) and all existing structures on the property (include underground items).
3. Identify all setbacks from proposed structure to the property line using feet.
4. Identify the distance between the proposed structure to existing surrounding structures.
5. Show street names.
6. Show parking spaces
7. Show trees to be removed as a result of this request. Include species, circumference of tree at chest height and approximate height. A separate tree removal application needs to be submitted.
8. Show dimensions of all impervious surfaces on property. Include pavers, decks, buildings, concrete, pools, etc. The city will use this information to conduct an impervious surface assessment.

COMMERCIAL SITE PLAN

Applicant site plan

The following must be included on the site plan. Measurements should be identified in feet.

1. Indicate North, South, East and West.
2. Identify location of proposed structure(s) and all existing structures on the property (include underground items).
3. Identify all setbacks from proposed structure to the property line using feet.
4. Identify the distance between the proposed structure to existing surrounding structures.
5. Show street names.
6. Show parking spaces and number the spaces. Identify ADA spaces.
7. Show trees to be removed. A separate tree removal application will need to be submitted.
8. Show dimensions of all impervious surfaces on property. Include pavers, decks, buildings, concrete, pools, etc. The city will use

